

# Soils Map

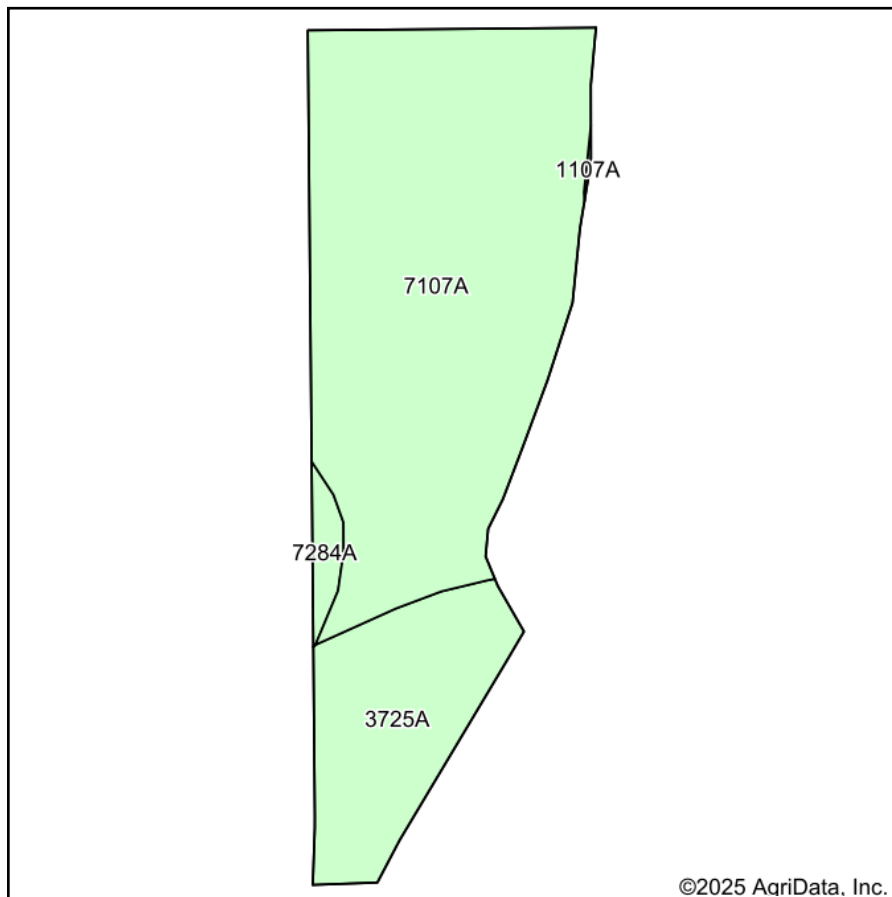

Soils data provided by USDA and NRCS.

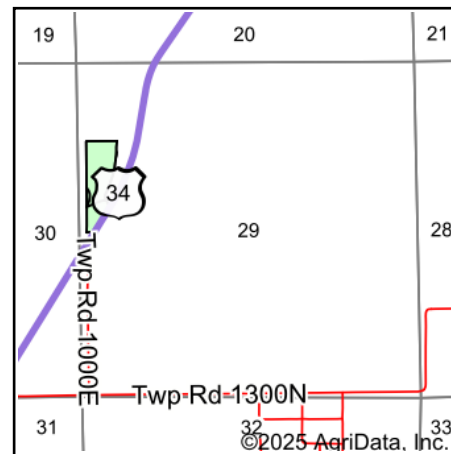

State: **Illinois**  
 County: **Henderson**  
 Location: **29-10N-5W**  
 Township: **Gladstone**  
 Acres: **11.58**  
 Date: **7/30/2025**



Maps Provided By:



Area Symbol: IL071, Soil Area Version: 26

Code	Soil Description	Acres	Percent of field	Subsoil rooting <sup>a</sup>	Corn Bu/A	Soybeans Bu/A	Wheat Bu/A	Oats Bu/A <sup>b</sup>	Sorghum <sup>c</sup> Bu/A	Grass-legume <sup>e</sup> hay, T/A	Crop productivity index for optimum management
**7107A	Sawmill silty clay loam, 0 to 2 percent slopes, rarely flooded	8.80	76.0%	FAV	**189	**60	**71	**98	**1	**6.00	**139
**3725A	Otter-Lawson silt loams, 0 to 2 percent slopes, frequently flooded	2.53	21.8%	FAV	**167	**55	**64	**84	0	**5.00	**125
**7284A	Tice silt loam, 0 to 2 percent slopes, rarely flooded	0.25	2.2%	FAV	**184	**57	**70	**95	0	**6.00	**134
Weighted Average					184.1	58.8	69.4	94.9	0.8	5.8	135.8

**Table: Optimum Crop Productivity Ratings for Illinois Soil EFOTG are sourced from Bulletin 811 calculated Map Unit Base Yield Indices, and adjusted (Adj) for slope, erosion, flooding, and surface texture.** Publication Date: 01-28-2025

Crop yields and productivity (B811 EFOTG) are maintained at the following USDA web site: 2023 Illinois Soil Productivity and Yield Indices: <https://efotg.sc.egov.usda.gov/#/state/IL/documents/section=2&folder=52809>

**\*\*** Base indexes from Bulletin 811 adjusted for slope, erosion, flooding, and surface texture according to the Il. Soils EFOTG

**b** Soils in the southern region were not rated for oats and are shown with a zero "0".

**c** Soils in the northern region or in both regions were not rated for grain sorghum and are shown with a zero "0".

**e** Soils in the well drained group were not rated for grass-legume and are shown with a zero "0".